

CAD-CAM



Product Catalog





CAD-CAM Overview

Adin's CAD - CAM components and digital libraries enable dentists and dental technicians to design and manufacture state-of-the-art restorations supported by Adin's implants, using current and up-to-date digital restoration processes.

The variety of components ensure endless restorative optionsa for treatment of single, partially, or full edentulous cases.

UniFit

Unified Conical Connection

Ø 3.5 Ø 3.75 Ø 4.3 Ø 5.0 Ø 6.0



Ti Base Abutments

Recommended Torque 35(Ncm)

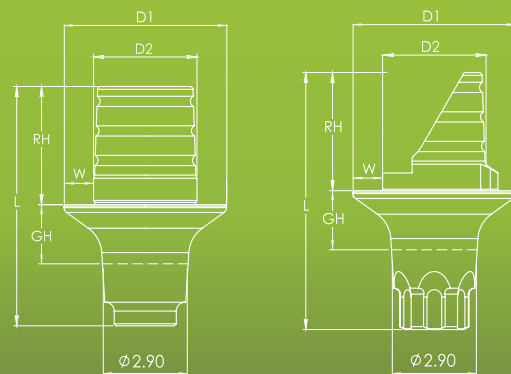

Ti Base UniFit Abutment, Engaged

| L | RH | GH | D1 | D2 | W | Catalog |
|------|----|----|-----|-----|-----|---------|
| 9.7 | 6 | 1 | 4.5 | 3.1 | 0.5 | TB07611 |
| 10.7 | 6 | 2 | 4.5 | 3.1 | 0.5 | TB07621 |
| 11.7 | 6 | 3 | 4.5 | 3.1 | 0.5 | TB07631 |
| 13.7 | 8 | 3 | 4.5 | 2.9 | 0.5 | TB07831 |



Ti Base UniFit Abutment, Engaged Wide

| L | RH | GH | D1 | D2 | W | Catalog |
|------|----|----|-----|-----|---|----------|
| 9.7 | 6 | 1 | 5.5 | 3.1 | 1 | TB07611W |
| 10.7 | 6 | 2 | 5.5 | 3.1 | 1 | TB07621W |
| 11.7 | 6 | 3 | 5.5 | 3.1 | 1 | TB07631W |
| 13.7 | 8 | 3 | 5.5 | 2.9 | 1 | TB07831W |



Ti Base UniFit Abutment, Non-Engaged

| L | RH | GH | D1 | D2 | W | Catalog |
|------|----|----|-----|-----|-----|---------|
| 9.0 | 6 | 1 | 4.5 | 3.1 | 0.5 | TB07612 |
| 10.0 | 6 | 2 | 4.5 | 3.1 | 0.5 | TB07622 |
| 11.0 | 6 | 3 | 4.5 | 3.1 | 0.5 | TB07632 |
| 13.0 | 8 | 3 | 4.5 | 2.9 | 0.5 | TB07832 |



Ti Base UniFit Abutment, Non-Engaged Wide

| L | RH | GH | D1 | D2 | W | Catalog |
|------|----|----|-----|-----|---|----------|
| 9.0 | 6 | 1 | 5.5 | 3.1 | 1 | TB07612W |
| 10.0 | 6 | 2 | 5.5 | 3.1 | 1 | TB07622W |
| 11.0 | 6 | 3 | 5.5 | 3.1 | 1 | TB07632W |
| 13.0 | 8 | 3 | 5.5 | 2.9 | 1 | TB07832W |



Ti Base UniFit Abutment, Angular

| L | RH | GH | D1 | D2 | W | Catalog |
|-----|----|----|-----|-----|-----|---------|
| 7.7 | 4 | 1 | 4.5 | 3.2 | 0.5 | TB07413 |
| 8.7 | 4 | 2 | 4.5 | 3.2 | 0.5 | TB07423 |
| 9.7 | 4 | 3 | 4.5 | 3.2 | 0.5 | TB07433 |

Recommended Torque 35(Ncm)

For further product information and use please refer to IFU028

C-Type Ti Base Abutments

Recommended Torque 35(Ncm)

For further product information and use please refer to IFU028

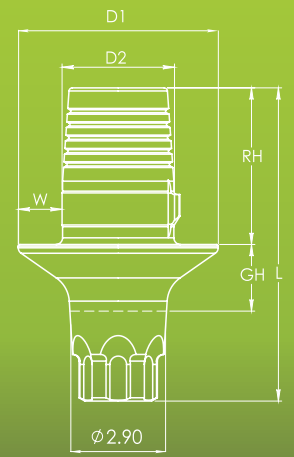

| | | L | RH | GH | D1 | D2 | W | Catalog |
|--|---|------|-----|----|-----|------|-----|---------|
|  | C-Type Ti Base UniFit Abutment, Engaged | 8.4 | 4.7 | 1 | 4.3 | 3.36 | 0.5 | TB07414 |
| | | 9.4 | 4.7 | 2 | 4.3 | 3.36 | 0.5 | TB07424 |
| | | 10.4 | 4.7 | 3 | 4.3 | 3.36 | 0.5 | TB07434 |

| | | L | RH | GH | D1 | D2 | W | Catalog |
|---|---|------|-----|----|-----|------|-----|----------|
|  | C-Type Ti Base UniFit Abutment, Engaged Wide | 8.4 | 4.7 | 1 | 4.3 | 3.36 | 0.5 | TB07414W |
| | | 9.4 | 4.7 | 2 | 4.3 | 3.36 | 0.5 | TB07424W |
| | | 10.4 | 4.7 | 3 | 4.3 | 3.36 | 0.5 | TB07434W |

| | | L | RH | GH | D1 | D2 | W | Catalog |
|--|---|----|-----|----|----|------|-----|---------|
|  | C-Type Ti Base UniFit Abutment, Non- Engaged | 8 | 4.7 | 1 | 6 | 3.36 | 1.3 | TB07415 |
| | | 9 | 4.7 | 2 | 6 | 3.36 | 1.3 | TB07425 |
| | | 10 | 4.7 | 3 | 6 | 3.36 | 1.3 | TB07435 |

| | | L | RH | GH | D1 | D2 | W | Catalog |
|---|---|----|-----|----|----|------|-----|----------|
|  | C-Type Ti Base UniFit Abutment, Non- Engaged Wide | 8 | 4.7 | 1 | 6 | 3.36 | 1.3 | TB07415W |
| | | 9 | 4.7 | 2 | 6 | 3.36 | 1.3 | TB07425W |
| | | 10 | 4.7 | 3 | 6 | 3.36 | 1.3 | TB07435W |

RS

Regular Standard Internal Hex

Ø 3.3 Ø 3.5 Ø 3.75 Ø 4.2 Ø 5.0 Ø 6.0

Touareg-S™ & Swell™

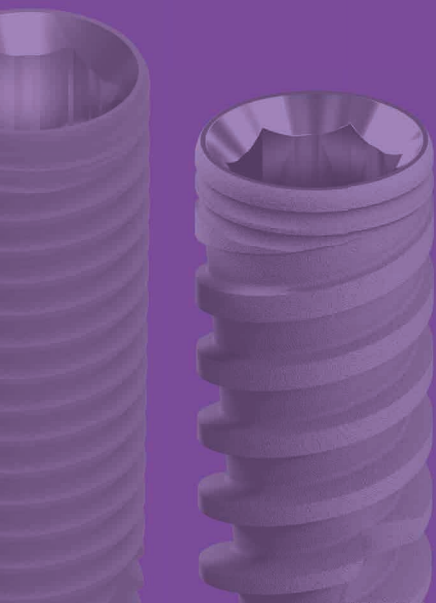

Scan body | For Intra-oral and Desktop Scanner

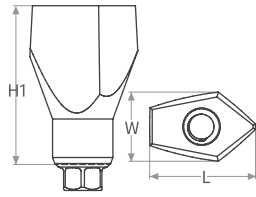

| | RS Scan Body 7mm | RS Scan Body 10mm |
|--------------------------|------------------------------------|-------------------------------------|
| Catalog No. | RS0088 | RS0089 |
| Retaining Screw Included | RS3400 | RS3425 |
| Material | Ti 6Al 4V ELI | Ti 6Al 4V ELI |
| Dimensions | H1: 7 mm W: 4.3 mm L: 6.7 mm | H1: 10 mm W: 4.4 mm L: 6.8 mm |

Ti Blanks | For Medentika PreFace® Holders

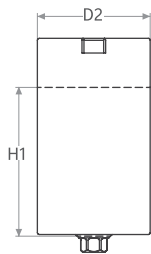

| | RS Ti Pre Milled MDTK Abutment Blank Ø 11.5mm | | RS Ti Pre Milled MDTK Abutment Blank Ø 15.8mm |
|--------------------------|---|--------------------------|---|
| Catalog No. | RS1411 | Catalog No. | RS1415 |
| Retaining Screw Included | RS3402 | Retaining Screw Included | RS3402 |
| Material | Ti 6Al 4V ELI | Material | Ti 6Al 4V ELI |
| Dimensions | H1: 15.2 mm D2: Ø11.5 mm | Dimensions | H1: 15.2 mm D2: Ø15.8 mm |
| Intended Use | customized abutment for single unit | Intended Use | customized abutment for single unit |

Ti Bases

Engaged

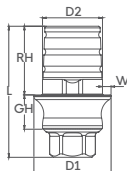

| | | RH | GH | D1 | D2 | L | W |
|----------------|---|----------|----------|------------|------------|-------------|------------|
| TB04411 | Ti Base RS Abutment, RH 4mm GH 1mm Engaged | 4 | 1 | 4.5 | 3.5 | 6.65 | 0.5 |
| TB04421 | Ti Base RS Abutment, RH 4mm GH 2mm Engaged | 4 | 2 | 4.5 | 3.5 | 7.65 | 0.5 |
| TB04431 | Ti Base RS Abutment, RH 4mm GH 3mm Engaged | 4 | 3 | 4.5 | 3.5 | 8.65 | 0.5 |
| TB04441 | Ti Base RS Abutment, RH 4mm GH 4mm Engaged | 4 | 4 | 4.5 | 3.5 | 9.65 | 0.5 |
| TB04611 | Ti Base RS Abutment, RH 6mm GH 1mm Engaged | 6 | 1 | 4.5 | 3.5 | 8.65 | 0.5 |

| | | RH | GH | D1 | D2 | L | W |
|---------|--|----|----|-----|-----|-------|-----|
| TB04621 | Ti Base RS Abutment, RH 6mm GH 2mm Engaged | 6 | 2 | 4.5 | 3.5 | 9.65 | 0.5 |
| TB04631 | Ti Base RS Abutment, RH 6mm GH 3mm Engaged | 6 | 3 | 4.5 | 3.5 | 10.65 | 0.5 |
| TB04641 | Ti Base RS Abutment, RH 6mm GH 4mm Engaged | 6 | 4 | 4.5 | 3.5 | 11.65 | 0.5 |
| TB04811 | Ti Base RS Abutment, RH 8mm GH 1mm Engaged | 8 | 1 | 4.5 | 3.5 | 10.65 | 0.5 |
| TB04821 | Ti Base RS Abutment, RH 8mm GH 2mm Engaged | 8 | 2 | 4.5 | 3.5 | 11.65 | 0.5 |
| TB04831 | Ti Base RS Abutment, RH 8mm GH 3mm Engaged | 8 | 3 | 4.5 | 3.5 | 12.65 | 0.5 |
| TB04841 | Ti Base RS Abutment, RH 8mm GH 4mm Engaged | 8 | 4 | 4.5 | 3.5 | 13.65 | 0.5 |

Engaged Wide

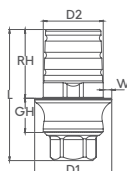

| | | RH | GH | D1 | D2 | L | W |
|----------|---|----|----|-----|-----|-------|---|
| TB04411W | Ti Base RS Abutment, RH 4mm GH 1mm Engaged Wide | 4 | 1 | 5.5 | 3.5 | 6.65 | 1 |
| TB04421W | Ti Base RS Abutment, RH 4mm GH 2mm Engaged Wide | 4 | 2 | 5.5 | 3.5 | 7.65 | 1 |
| TB04431W | Ti Base RS Abutment, RH 4mm GH 3mm Engaged Wide | 4 | 3 | 5.5 | 3.5 | 8.65 | 1 |
| TB04441W | Ti Base RS Abutment, RH 4mm GH 4mm Engaged Wide | 4 | 4 | 5.5 | 3.5 | 9.65 | 1 |
| TB04611W | Ti Base RS Abutment, RH 6mm GH 1mm Engaged Wide | 6 | 1 | 5.5 | 3.5 | 8.65 | 1 |
| TB04621W | Ti Base RS Abutment, RH 6mm GH 2mm Engaged Wide | 6 | 2 | 5.5 | 3.5 | 9.65 | 1 |
| TB04631W | Ti Base RS Abutment, RH 6mm GH 3mm Engaged Wide | 6 | 3 | 5.5 | 3.5 | 10.65 | 1 |
| TB04641W | Ti Base RS Abutment, RH 6mm GH 4mm Engaged Wide | 6 | 4 | 5.5 | 3.5 | 11.65 | 1 |
| TB04811W | Ti Base RS Abutment, RH 8mm GH 1mm Engaged Wide | 8 | 1 | 5.5 | 3.5 | 10.65 | 1 |
| TB04821W | Ti Base RS Abutment, RH 8mm GH 2mm Engaged Wide | 8 | 2 | 5.5 | 3.5 | 11.65 | 1 |
| TB04831W | Ti Base RS Abutment, RH 8mm GH 3mm Engaged Wide | 8 | 3 | 5.5 | 3.5 | 12.65 | 1 |
| TB04841W | Ti Base RS Abutment, RH 8mm GH 4mm Engaged Wide | 8 | 4 | 5.5 | 3.5 | 13.65 | 1 |

Non Engaged

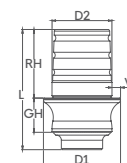

| | | RH | GH | D1 | D2 | L | W |
|---------|--|----|----|-----|-----|----|-----|
| TB04412 | Ti Base RS Abutment, RH 4mm GH 1mm Non Engaged | 4 | 1 | 4.5 | 3.5 | 6 | 0.5 |
| TB04422 | Ti Base RS Abutment, RH 4mm GH 2mm Non Engaged | 4 | 2 | 4.5 | 3.5 | 7 | 0.5 |
| TB04432 | Ti Base RS Abutment, RH 4mm GH 3mm Non Engaged | 4 | 3 | 4.5 | 3.5 | 8 | 0.5 |
| TB04442 | Ti Base RS Abutment, RH 4mm GH 4mm Non Engaged | 4 | 4 | 4.5 | 3.5 | 9 | 0.5 |
| TB04612 | Ti Base RS Abutment, RH 6mm GH 1mm Non Engaged | 6 | 1 | 4.5 | 3.5 | 8 | 0.5 |
| TB04622 | Ti Base RS Abutment, RH 6mm GH 2mm Non Engaged | 6 | 2 | 4.5 | 3.5 | 9 | 0.5 |
| TB04632 | Ti Base RS Abutment, RH 6mm GH 3mm Non Engaged | 6 | 3 | 4.5 | 3.5 | 10 | 0.5 |
| TB04642 | Ti Base RS Abutment, RH 6mm GH 4mm Non Engaged | 6 | 4 | 4.5 | 3.5 | 11 | 0.5 |
| TB04812 | Ti Base RS Abutment, RH 8mm GH 1mm Non Engaged | 8 | 1 | 4.5 | 3.5 | 10 | 0.5 |
| TB04822 | Ti Base RS Abutment, RH 8mm GH 2mm Non Engaged | 8 | 2 | 4.5 | 3.5 | 11 | 0.5 |

| | | RH | GH | D2 | D1 | L | W |
|---------|--|----|----|-----|-----|----|-----|
| TB04832 | Ti Base RS Abutment, RH 8mm GH 3mm Non Engaged | 8 | 3 | 4.5 | 3.5 | 12 | 0.5 |
| TB04842 | Ti Base RS Abutment, RH 8mm GH 4mm Non Engaged | 8 | 4 | 4.5 | 3.5 | 13 | 0.5 |

Non Engaged Wide

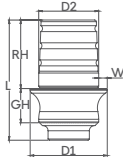

| | | RH | GH | D1 | D2 | L | W |
|----------|---|----|----|-----|-----|----|---|
| TB04412W | Ti Base RS Abutment, RH 4mm GH 1mm Non Engaged Wide | 4 | 1 | 5.5 | 3.5 | 6 | 1 |
| TB04422W | Ti Base RS Abutment, RH 4mm GH 2mm Non Engaged Wide | 4 | 2 | 5.5 | 3.5 | 7 | 1 |
| TB04432W | Ti Base RS Abutment, RH 4mm GH 3mm Non Engaged Wide | 4 | 3 | 5.5 | 3.5 | 8 | 1 |
| TB04442W | Ti Base RS Abutment, RH 4mm GH 4mm Non Engaged Wide | 4 | 4 | 5.5 | 3.5 | 9 | 1 |
| TB04612W | Ti Base RS Abutment, RH 6mm GH 1mm Non Engaged Wide | 6 | 1 | 5.5 | 3.5 | 8 | 1 |
| TB04622W | Ti Base RS Abutment, RH 6mm GH 2mm Non Engaged Wide | 6 | 2 | 5.5 | 3.5 | 9 | 1 |
| TB04632W | Ti Base RS Abutment, RH 6mm GH 3mm Non Engaged Wide | 6 | 3 | 5.5 | 3.5 | 10 | 1 |
| TB04642W | Ti Base RS Abutment, RH 6mm GH 4mm Non Engaged Wide | 6 | 4 | 5.5 | 3.5 | 11 | 1 |
| TB04812W | Ti Base RS Abutment, RH 8mm GH 1mm Non Engaged Wide | 8 | 1 | 5.5 | 3.5 | 10 | 1 |
| TB04822W | Ti Base RS Abutment, RH 8mm GH 2mm Non Engaged Wide | 8 | 2 | 5.5 | 3.5 | 11 | 1 |
| TB04832W | Ti Base RS Abutment, RH 8mm GH 3mm Non Engaged Wide | 8 | 3 | 5.5 | 3.5 | 12 | 1 |
| TB04842W | Ti Base RS Abutment, RH 8mm GH 4mm Non Engaged Wide | 8 | 4 | 5.5 | 3.5 | 13 | 1 |

Angular Engaged

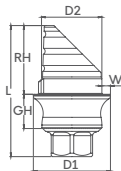

| | | RH | GH | D1 | D2 | L | W |
|---------|--|----|----|-----|-----|-------|-----|
| TB04413 | Ti Base RS Abutment, RH 4mm GH 1mm Angular Engaged | 4 | 1 | 4.5 | 3.5 | 6.65 | 0.5 |
| TB04423 | Ti Base RS Abutment, RH 4mm GH 2mm Angular Engaged | 4 | 2 | 4.5 | 3.5 | 7.65 | 0.5 |
| TB04433 | Ti Base RS Abutment, RH 4mm GH 3mm Angular Engaged | 4 | 3 | 4.5 | 3.5 | 8.65 | 0.5 |
| TB04443 | Ti Base RS Abutment, RH 4mm GH 4mm Angular Engaged | 4 | 4 | 4.5 | 3.5 | 9.65 | 0.5 |
| TB04613 | Ti Base RS Abutment, RH 6mm GH 1mm Angular Engaged | 6 | 1 | 4.5 | 3.5 | 8.65 | 0.5 |
| TB04623 | Ti Base RS Abutment, RH 6mm GH 2mm Angular Engaged | 6 | 2 | 4.5 | 3.5 | 9.65 | 0.5 |
| TB04633 | Ti Base RS Abutment, RH 6mm GH 3mm Angular Engaged | 6 | 3 | 4.5 | 3.5 | 10.65 | 0.5 |
| TB04643 | Ti Base RS Abutment, RH 6mm GH 4mm Angular Engaged | 6 | 4 | 4.5 | 3.5 | 11.65 | 0.5 |
| TB04813 | Ti Base RS Abutment, RH 8mm GH 1mm Angular Engaged | 8 | 1 | 4.5 | 3.5 | 10.65 | 0.5 |
| TB04823 | Ti Base RS Abutment, RH 8mm GH 2mm Angular Engaged | 8 | 2 | 4.5 | 3.5 | 11.65 | 0.5 |
| TB04833 | Ti Base RS Abutment, RH 8mm GH 3mm Angular Engaged | 8 | 3 | 4.5 | 3.5 | 12.65 | 0.5 |
| TB04843 | Ti Base RS Abutment, RH 8mm GH 4mm Angular Engaged | 8 | 4 | 4.5 | 3.5 | 13.65 | 0.5 |

Angular Engaged Wide

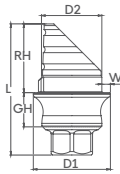

| | | RH | GH | D1 | D2 | L | A | W |
|----------|---|----|----|-----|-----|-------|----|---|
| TB04413W | Ti Base RS Abutment, RH 4mm GH 1mm Angular Engaged Wide | 4 | 1 | 5.5 | 3.5 | 6.65 | 45 | 1 |
| TB04423W | Ti Base RS Abutment, RH 4mm GH 2mm Angular Engaged Wide | 4 | 2 | 5.5 | 3.5 | 7.65 | 45 | 1 |
| TB04433W | Ti Base RS Abutment, RH 4mm GH 3mm Angular Engaged Wide | 4 | 3 | 5.5 | 3.5 | 8.65 | 45 | 1 |
| TB04443W | Ti Base RS Abutment, RH 4mm GH 4mm Angular Engaged Wide | 4 | 4 | 5.5 | 3.5 | 9.65 | 45 | 1 |
| TB04613W | Ti Base RS Abutment, RH 6mm GH 1mm Angular Engaged Wide | 6 | 1 | 5.5 | 3.5 | 8.65 | 35 | 1 |
| TB04623W | Ti Base RS Abutment, RH 6mm GH 2mm Angular Engaged Wide | 6 | 2 | 5.5 | 3.5 | 9.65 | 35 | 1 |
| TB04633W | Ti Base RS Abutment, RH 6mm GH 3mm Angular Engaged Wide | 6 | 3 | 5.5 | 3.5 | 10.65 | 35 | 1 |
| TB04643W | Ti Base RS Abutment, RH 6mm GH 4mm Angular Engaged Wide | 6 | 4 | 5.5 | 3.5 | 11.65 | 35 | 1 |
| TB04813W | Ti Base RS Abutment, RH 8mm GH 1mm Angular Engaged Wide | 8 | 1 | 5.5 | 3.5 | 10.65 | 25 | 1 |
| TB04823W | Ti Base RS Abutment, RH 8mm GH 2mm Angular Engaged Wide | 8 | 2 | 5.5 | 3.5 | 11.65 | 25 | 1 |
| TB04833W | Ti Base RS Abutment, RH 8mm GH 3mm Angular Engaged Wide | 8 | 3 | 5.5 | 3.5 | 12.65 | 25 | 1 |
| TB04843W | Ti Base RS Abutment, RH 8mm GH 4mm Angular Engaged Wide | 8 | 4 | 5.5 | 3.5 | 13.65 | 25 | 1 |

C-Type Ti Bases | For further product information and use please refer to IFU028

Engaged

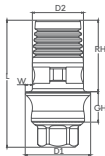

| | | RH | GH | D1 | D2 | L | W | Post |
|---------|--|-----|----|-----|------|-------|-----|-------|
| TB04414 | C-Type Ti Base RS Abutment, GH 1mm Engaged | 4.7 | 1 | 4.3 | 3.36 | 7.35 | 0.5 | Large |
| TB04424 | C-Type Ti Base RS Abutment, GH 2mm Engaged | 4.7 | 2 | 4.3 | 3.36 | 8.35 | 0.5 | Large |
| TB04434 | C-Type Ti Base RS Abutment, GH 3mm Engaged | 4.7 | 3 | 4.3 | 3.36 | 9.35 | 0.5 | Large |
| TB04444 | C-Type Ti Base RS Abutment, GH 4mm Engaged | 4.7 | 4 | 4.3 | 3.36 | 10.35 | 0.5 | Large |

Engaged Wide

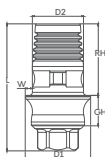

| | | RH | GH | D1 | D2 | L | W | Post |
|----------|---|-----|----|----|------|-------|-----|-------|
| TB04414W | C-Type Ti Base RS Abutment, GH 1mm Engaged Wide | 4.7 | 1 | 6 | 3.36 | 7.35 | 1.3 | Large |
| TB04424W | C-Type Ti Base RS Abutment, GH 2mm Engaged Wide | 4.7 | 2 | 6 | 3.36 | 8.35 | 1.3 | Large |
| TB04434W | C-Type Ti Base RS Abutment, GH 3mm Engaged Wide | 4.7 | 3 | 6 | 3.36 | 9.35 | 1.3 | Large |
| TB04444W | C-Type Ti Base RS Abutment, GH 4mm Engaged Wide | 4.7 | 4 | 6 | 3.36 | 10.35 | 1.3 | Large |

Non Engaged

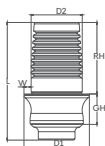

| | | RH | GH | D1 | D2 | L | W | Post |
|---------|--|-----|----|-----|------|-----|-----|-------|
| TB04415 | C-Type Ti Base RS Abutment, GH 1mm Non Engaged | 4.7 | 1 | 4.3 | 3.36 | 6.7 | 0.5 | Large |
| TB04425 | C-Type Ti Base RS Abutment, GH 2mm Non Engaged | 4.7 | 2 | 4.3 | 3.36 | 7.7 | 0.5 | Large |
| TB04435 | C-Type Ti Base RS Abutment, GH 3mm Non Engaged | 4.7 | 3 | 4.3 | 3.36 | 8.7 | 0.5 | Large |
| TB04445 | C-Type Ti Base RS Abutment, GH 4mm Non Engaged | 4.7 | 4 | 4.3 | 3.36 | 9.7 | 0.5 | Large |

Non Engaged Wide

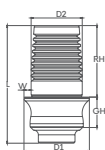

| | | RH | GH | D1 | D2 | L | W | Post |
|----------|---|-----|----|----|------|-----|-----|-------|
| TB04415W | C-Type Ti Base RS Abutment, GH 1mm Non Engaged Wide | 4.7 | 1 | 6 | 3.36 | 6.7 | 1.3 | Large |
| TB04425W | C-Type Ti Base RS Abutment, GH 2mm Non Engaged Wide | 4.7 | 2 | 6 | 3.36 | 7.7 | 1.3 | Large |
| TB04435W | C-Type Ti Base RS Abutment, GH 3mm Non Engaged Wide | 4.7 | 3 | 6 | 3.36 | 8.7 | 1.3 | Large |
| TB04445W | C-Type Ti Base RS Abutment, GH 4mm Non Engaged Wide | 4.7 | 4 | 6 | 3.36 | 9.7 | 1.3 | Large |

Conical Connection

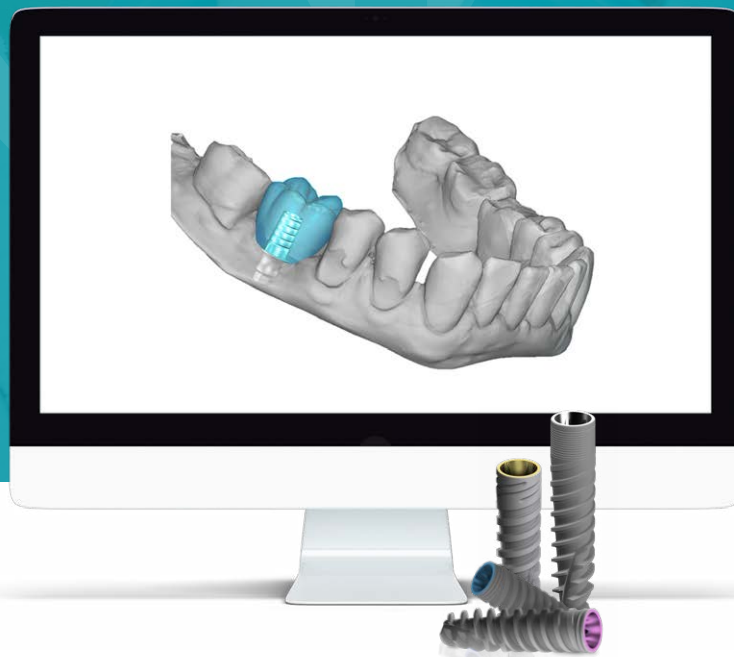

Ø 2.75 Ø 3.0 Ø 3.5 Ø 4.3 Ø 5.0

CloseFit™ - UNP | NP | RP | WP

CloseFit™ UNP

Conical-Hex Connection

Ø 2.75

Ultra Narrow Platform for narrowest ridges and tight spaces

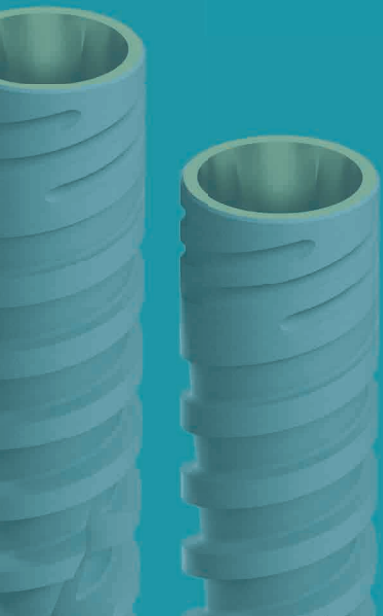



CloseFit™ UNP



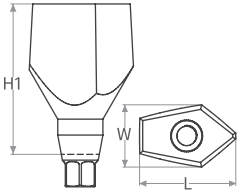

Ultra Narrow Platform for narrowest ridges and tight spaces

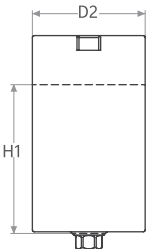

Scan body | For Intra-oral and Desktop Scanner

| | UNP CloseFit™ Scan Body 7mm | UNP CloseFit™ Scan Body 10mm |
|--|--|--|
|  |  |  |
| Catalog No. | UNP0088 | UNP0089 |
| Retaining Screw Included | UNP0001 | UNP0001 |
| Material | Ti 6Al 4V ELI | Ti 6Al 4V ELI |
| Dimensions | H1: 7 mm W: 4.2 mm L: 6.7 mm | H1: 10 mm W: 4.5 mm L: 6.9 mm |

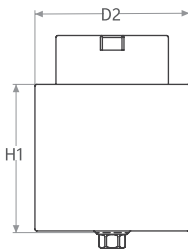
Ti Blanks | For Medentika PreFace® Holders

| | UNP CloseFit™ Ti Pre Milled MDTK Abutment Blank Ø11.5mm | | UNP CloseFit™ Ti Pre Milled MDTK Abutment Blank Ø15.8mm |
|---|---|---|---|
|  |  |  |  |
| Catalog No. | UNP1711 | Catalog No. | UNP1715 |
| Retaining Screw Included | UNP0001 | Retaining Screw Included | UNP0001 |
| Material | Ti 6Al 4V ELI | Material | Ti 6Al 4V ELI |
| Dimensions | H1: 15.4 mm D2: Ø11.5 mm | Dimensions | H1: 15.4 mm D2: Ø15.8 mm |
| Intended Use | customized abutment for single unit | Intended Use | customized abutment for single unit |

Ti Bases

Engaged

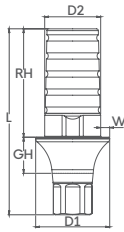

| | | RH | GH | D1 | D2 | L | W |
|----------------|--|----------|------------|------------|------------|-------------|------------|
| TB06411 | Ti Base UNP Abutment, RH 4mm GH 1.5mm Engaged | 4 | 1.5 | 4.1 | 3.1 | 7.8 | 0.5 |
| TB06421 | Ti Base UNP Abutment, RH 4mm GH 2mm Engaged | 4 | 2 | 4.1 | 3.1 | 8.3 | 0.5 |
| TB06431 | Ti Base UNP Abutment, RH 4mm GH 3mm Engaged | 4 | 3 | 4.1 | 3.1 | 9.3 | 0.5 |
| TB06441 | Ti Base UNP Abutment, RH 4mm GH 4mm Engaged | 4 | 4 | 4.1 | 3.1 | 10.3 | 0.5 |
| TB06611 | Ti Base UNP Abutment, RH 6mm GH 1.5mm Engaged | 6 | 1.5 | 4.1 | 3.1 | 9.8 | 0.5 |
| TB06621 | Ti Base UNP Abutment, RH 6mm GH 2mm Engaged | 6 | 2 | 4.1 | 3.1 | 10.3 | 0.5 |
| TB06631 | Ti Base UNP Abutment, RH 6mm GH 3mm Engaged | 6 | 3 | 4.1 | 3.1 | 11.3 | 0.5 |
| TB06641 | Ti Base UNP Abutment, RH 6mm GH 4mm Engaged | 6 | 4 | 4.1 | 3.1 | 12.3 | 0.5 |
| TB06811 | Ti Base UNP Abutment, RH 8mm GH 1.5mm Engaged | 8 | 1.5 | 4.1 | 3.1 | 11.8 | 0.5 |
| TB06821 | Ti Base UNP Abutment, RH 8mm GH 2mm Engaged | 8 | 2 | 4.1 | 3.1 | 12.3 | 0.5 |

Non Engaged

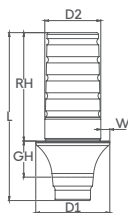

| | | RH | GH | D1 | D2 | L | W |
|----------------|--|----------|------------|------------|------------|-------------|------------|
| TB06412 | Ti Base UNP Abutment, RH 4mm GH 1.5mm Non Engaged | 4 | 1.5 | 4.1 | 3.1 | 6.8 | 0.5 |
| TB06422 | Ti Base UNP Abutment, RH 4mm GH 2mm Non Engaged | 4 | 2 | 4.1 | 3.1 | 7.3 | 0.5 |
| TB06432 | Ti Base UNP Abutment, RH 4mm GH 3mm Non Engaged | 4 | 3 | 4.1 | 3.1 | 8.3 | 0.5 |
| TB06442 | Ti Base UNP Abutment, RH 4mm GH 4mm Non Engaged | 4 | 4 | 4.1 | 3.1 | 9.3 | 0.5 |
| TB06612 | Ti Base UNP Abutment, RH 6mm GH 1.5mm Non Engaged | 6 | 1.5 | 4.1 | 3.1 | 8.8 | 0.5 |
| TB06622 | Ti Base UNP Abutment, RH 6mm GH 2mm Non Engaged | 6 | 2 | 4.1 | 3.1 | 9.3 | 0.5 |
| TB06632 | Ti Base UNP Abutment, RH 6mm GH 3mm Non Engaged | 6 | 3 | 4.1 | 3.1 | 10.3 | 0.5 |
| TB06642 | Ti Base UNP Abutment, RH 6mm GH 4mm Non Engaged | 6 | 4 | 4.1 | 3.1 | 11.3 | 0.5 |
| TB06812 | Ti Base UNP Abutment, RH 8mm GH 1.5mm Non Engaged | 8 | 1.5 | 4.1 | 3.1 | 10.8 | 0.5 |
| TB06822 | Ti Base UNP Abutment, RH 8mm GH 2mm Non Engaged | 8 | 2 | 4.1 | 3.1 | 11.3 | 0.5 |

Angular Engaged

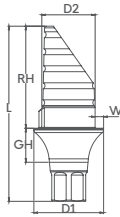

| | | RH | GH | D1 | D2 | L | W |
|----------------|--|----------|------------|------------|------------|-------------|------------|
| TB06413 | Ti Base UNP Abutment, RH 4mm GH 1.5mm Angular Engaged | 4 | 1.5 | 4.1 | 3.1 | 7.8 | 0.5 |
| TB06423 | Ti Base UNP Abutment, RH 4mm GH 2mm Angular Engaged | 4 | 2 | 4.1 | 3.1 | 8.3 | 0.5 |
| TB06433 | Ti Base UNP Abutment, RH 4mm GH 3mm Angular Engaged | 4 | 3 | 4.1 | 3.1 | 9.3 | 0.5 |
| TB06443 | Ti Base UNP Abutment, RH 4mm GH 4mm Angular Engaged | 4 | 4 | 4.1 | 3.1 | 10.3 | 0.5 |
| TB06613 | Ti Base UNP Abutment, RH 6mm GH 1.5mm Angular Engaged | 6 | 1.5 | 4.1 | 3.1 | 9.8 | 0.5 |
| TB06623 | Ti Base UNP Abutment, RH 6mm GH 2mm Angular Engaged | 6 | 2 | 4.1 | 3.1 | 10.3 | 0.5 |
| TB06633 | Ti Base UNP Abutment, RH 6mm GH 3mm Angular Engaged | 6 | 3 | 4.1 | 3.1 | 11.3 | 0.5 |
| TB06643 | Ti Base UNP Abutment, RH 6mm GH 4mm Angular Engaged | 6 | 4 | 4.1 | 3.1 | 12.3 | 0.5 |
| TB06813 | Ti Base UNP Abutment, RH 8mm GH 1.5mm Angular Engaged | 8 | 1.5 | 4.1 | 3.1 | 11.8 | 0.5 |
| TB06823 | Ti Base UNP Abutment, RH 8mm GH 2mm Angular Engaged | 8 | 2 | 4.1 | 3.1 | 12.3 | 0.5 |

C-Type Ti Bases | For further product information and use please refer to IFU028

Engaged

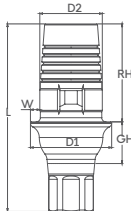

| | | RH | GH | D1 | D2 | L | W | Post |
|---------|---|-----|-----|-----|----|-----|------|-------|
| TB06414 | C-Type Ti Base UNP Abutment, GH 1.5mm Engaged | 4.7 | 1.5 | 3.9 | 3 | 8.5 | 0.45 | Small |
| TB06424 | C-Type Ti Base UNP Abutment, GH 2mm Engaged | 4.7 | 2 | 3.9 | 3 | 9 | 0.45 | Small |
| TB06434 | C-Type Ti Base UNP Abutment, GH 3mm Engaged | 4.7 | 3 | 3.9 | 3 | 10 | 0.45 | Small |
| TB06444 | C-Type Ti Base UNP Abutment, GH 4mm Engaged | 4.7 | 4 | 3.9 | 3 | 11 | 0.45 | Small |

Non Engaged

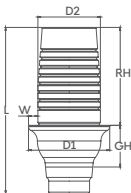

| | | RH | GH | D1 | D2 | L | W | Post |
|---------|---|-----|-----|-----|----|-----|------|-------|
| TB06415 | C-Type Ti Base UNP Abutment, GH 1.5mm Non Engaged | 4.7 | 1.5 | 3.9 | 3 | 8.5 | 0.45 | Small |
| TB06425 | C-Type Ti Base UNP Abutment, GH 2mm Non Engaged | 4.7 | 2 | 3.9 | 3 | 9 | 0.45 | Small |
| TB06435 | C-Type Ti Base UNP Abutment, GH 3mm Non Engaged | 4.7 | 3 | 3.9 | 3 | 10 | 0.45 | Small |
| TB06445 | C-Type Ti Base UNP Abutment, GH 4mm Non Engaged | 4.7 | 4 | 3.9 | 3 | 11 | 0.45 | Small |

CloseFit™ NP

Conical-Hex Connection

Ø 3.0

Narrow Platform for narrow ridges and tight spaces

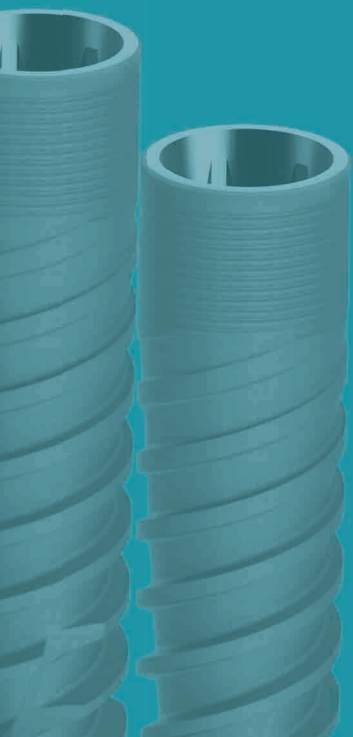



CloseFit™ NP

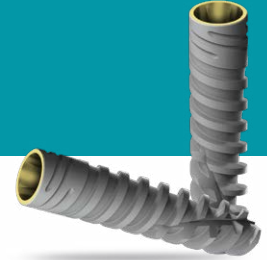

Narrow Platform for narrow ridges and tight spaces



Scan body | For Intra-oral and Desktop Scanner

| | NP CloseFit™ Scan Body 7mm | NP CloseFit™ Scan Body 10mm |
|--------------------------|--|--|
| |  |  |
| Catalog No. | NP0088 | NP0089 |
| Retaining Screw Included | NP0001 | NP0001 |
| Material | Ti 6Al 4V ELI | Ti 6Al 4V ELI |
| Dimensions | H1: 7 mm W: 4.2 mm L: 6.7 mm | H1: 10 mm W: 4.5 mm L: 6.9 mm |

Ti Blanks | For Medentika PreFace® Holders

| | NP CloseFit™ Ti Pre Milled MDTK Abutment Blank Ø11.5mm | | NP CloseFit™ Ti Pre Milled MDTK Abutment Blank Ø15.8mm |
|--------------------------|---|--------------------------|---|
| |  | |  |
| Catalog No. | NP1111 | Catalog No. | NP1115 |
| Retaining Screw Included | NP0001 | Retaining Screw Included | NP0001 |
| Material | Ti 6Al 4V ELI | Material | Ti 6Al 4V ELI |
| Dimensions | H1: 15.4 mm D2: Ø11.5 mm | Dimensions | H1: 15.4 mm D2: Ø15.8 mm |
| Intended Use | customized abutment for single unit | Intended Use | customized abutment for single unit |

Ti Bases

Engaged

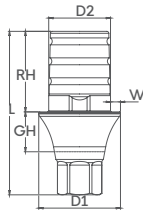

| | | RH | GH | D1 | D2 | L | W |
|----------------|---|----------|------------|------------|------------|-------------|------------|
| TB02411 | Ti Base NP Abutment, RH 4mm GH 1.5mm Engaged | 4 | 1.5 | 4.1 | 3.1 | 7.7 | 0.5 |
| TB02421 | Ti Base NP Abutment, RH 4mm GH 2mm Engaged | 4 | 2 | 4.1 | 3.1 | 8.2 | 0.5 |
| TB02431 | Ti Base NP Abutment, RH 4mm GH 3mm Engaged | 4 | 3 | 4.1 | 3.1 | 9.2 | 0.5 |
| TB02441 | Ti Base NP Abutment, RH 4mm GH 4mm Engaged | 4 | 4 | 4.1 | 3.1 | 10.2 | 0.5 |
| TB02611 | Ti Base NP Abutment, RH 6mm GH 1.5mm Engaged | 6 | 1.5 | 4.1 | 3.1 | 9.7 | 0.5 |
| TB02621 | Ti Base NP Abutment, RH 6mm GH 2mm Engaged | 6 | 2 | 4.1 | 3.1 | 10.2 | 0.5 |
| TB02631 | Ti Base NP Abutment, RH 6mm GH 3mm Engaged | 6 | 3 | 4.1 | 3.1 | 11.2 | 0.5 |
| TB02641 | Ti Base NP Abutment, RH 6mm GH 4mm Engaged | 6 | 4 | 4.1 | 3.1 | 12.2 | 0.5 |
| TB02811 | Ti Base NP Abutment, RH 8mm GH 1.5mm Engaged | 8 | 1.5 | 4.1 | 3.1 | 11.7 | 0.5 |
| TB02821 | Ti Base NP Abutment, RH 8mm GH 2mm Engaged | 8 | 2 | 4.1 | 3.1 | 12.2 | 0.5 |

Non Engaged

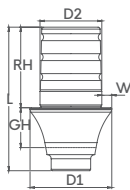

| | | RH | GH | D1 | D2 | L | W |
|----------------|---|----------|------------|------------|------------|-------------|------------|
| TB02412 | Ti Base NP Abutment, RH 4mm GH 1.5mm Non Engaged | 4 | 1.5 | 4.1 | 3.1 | 6.7 | 0.5 |
| TB02422 | Ti Base NP Abutment, RH 4mm GH 2mm Non Engaged | 4 | 2 | 4.1 | 3.1 | 7.2 | 0.5 |
| TB02432 | Ti Base NP Abutment, RH 4mm GH 3mm Non Engaged | 4 | 3 | 4.1 | 3.1 | 8.2 | 0.5 |
| TB02442 | Ti Base NP Abutment, RH 4mm GH 4mm Non Engaged | 4 | 4 | 4.1 | 3.1 | 9.2 | 0.5 |
| TB02612 | Ti Base NP Abutment, RH 6mm GH 1.5mm Non Engaged | 6 | 1.5 | 4.1 | 3.1 | 8.7 | 0.5 |
| TB02622 | Ti Base NP Abutment, RH 6mm GH 2mm Non Engaged | 6 | 2 | 4.1 | 3.1 | 9.2 | 0.5 |
| TB02632 | Ti Base NP Abutment, RH 6mm GH 3mm Non Engaged | 6 | 3 | 4.1 | 3.1 | 10.2 | 0.5 |
| TB02642 | Ti Base NP Abutment, RH 6mm GH 4mm Non Engaged | 6 | 4 | 4.1 | 3.1 | 11.2 | 0.5 |
| TB02812 | Ti Base NP Abutment, RH 8mm GH 1.5mm Non Engaged | 8 | 1.5 | 4.1 | 3.1 | 10.7 | 0.5 |
| TB02822 | Ti Base NP Abutment, RH 8mm GH 2mm Non Engaged | 8 | 2 | 4.1 | 3.1 | 11.2 | 0.5 |

Angular Engaged

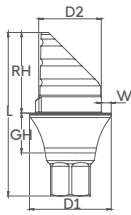

| | | RH | GH | D1 | D2 | L | W |
|----------------|---|----------|------------|------------|------------|-------------|------------|
| TB02413 | Ti Base NP Abutment, RH 4mm GH 1.5mm Angular Engaged | 4 | 1.5 | 4.1 | 3.1 | 7.7 | 0.5 |
| TB02423 | Ti Base NP Abutment, RH 4mm GH 2mm Angular Engaged | 4 | 2 | 4.1 | 3.1 | 8.2 | 0.5 |
| TB02433 | Ti Base NP Abutment, RH 4mm GH 3mm Angular Engaged | 4 | 3 | 4.1 | 3.1 | 9.2 | 0.5 |
| TB02443 | Ti Base NP Abutment, RH 4mm GH 4mm Angular Engaged | 4 | 4 | 4.1 | 3.1 | 10.2 | 0.5 |
| TB02613 | Ti Base NP Abutment, RH 6mm GH 1.5mm Angular Engaged | 6 | 1.5 | 4.1 | 3.1 | 9.7 | 0.5 |
| TB02623 | Ti Base NP Abutment, RH 6mm GH 2mm Angular Engaged | 6 | 2 | 4.1 | 3.1 | 10.2 | 0.5 |
| TB02633 | Ti Base NP Abutment, RH 6mm GH 3mm Angular Engaged | 6 | 3 | 4.1 | 3.1 | 11.2 | 0.5 |
| TB02643 | Ti Base NP Abutment, RH 6mm GH 4mm Angular Engaged | 6 | 4 | 4.1 | 3.1 | 12.2 | 0.5 |
| TB02813 | Ti Base NP Abutment, RH 8mm GH 1.5mm Angular Engaged | 8 | 1.5 | 4.1 | 3.1 | 11.7 | 0.5 |
| TB02823 | Ti Base NP Abutment, RH 8mm GH 2mm Angular Engaged | 8 | 2 | 4.1 | 3.1 | 12.2 | 0.5 |

C-Type Ti Bases | For further product information and use please refer to IFU028

Engaged

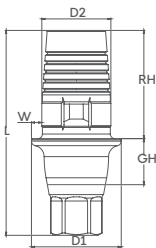

| | | RH | GH | D1 | D2 | L | W | Post |
|---------|--|-----|-----|-----|----|-------|------|-------|
| TB02414 | C-Type Ti Base NP Abutment, GH 1.5mm Engaged | 4.7 | 1.5 | 3.9 | 3 | 8.36 | 0.45 | Small |
| TB02424 | C-Type Ti Base NP Abutment, GH 2mm Engaged | 4.7 | 2 | 3.9 | 3 | 8.86 | 0.45 | Small |
| TB02434 | C-Type Ti Base NP Abutment, GH 3mm Engaged | 4.7 | 3 | 3.9 | 3 | 9.86 | 0.45 | Small |
| TB02444 | C-Type Ti Base NP Abutment, GH 4mm Engaged | 4.7 | 4 | 3.9 | 3 | 10.86 | 0.45 | Small |

CloseFit™ RP

Conical-Hex Connection

Ø3.5

Regular Platform

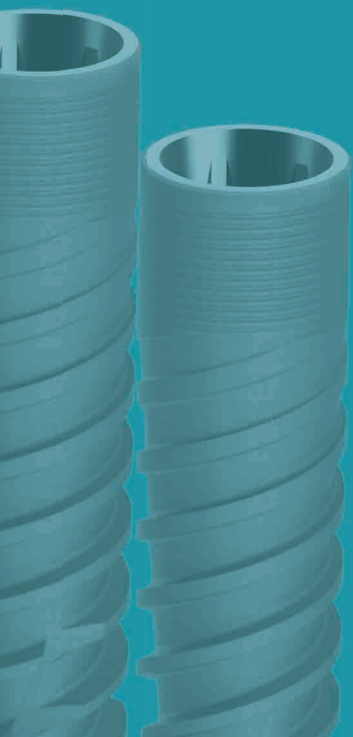

Non Engaged

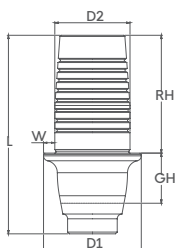

| | | RH | GH | D1 | D2 | L | W | Post |
|---------|--|-----|-----|-----|-----|-----|-----|-------|
| TB02415 | C-Type Ti Base NP Abutment, GH 1.5mm Non Engaged | 4.7 | 1.5 | 4.1 | 3.1 | 6.8 | 0.5 | Small |
| TB02425 | C-Type Ti Base NP Abutment, GH 2mm Non Engaged | 4.7 | 2 | 4.1 | 3.1 | 7.3 | 0.5 | Small |
| TB02435 | C-Type Ti Base NP Abutment, GH 3mm Non Engaged | 4.7 | 3 | 4.1 | 3.1 | 8.3 | 0.5 | Small |
| TB02445 | C-Type Ti Base NP Abutment, GH 4mm Non Engaged | 4.7 | 4 | 4.1 | 3.1 | 9.3 | 0.5 | Small |

CloseFit™ RP

Regular Platform for standard size ridges and spaces

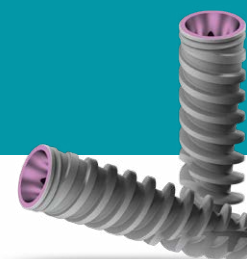

Scan body | For Intra-oral and Desktop Scanner

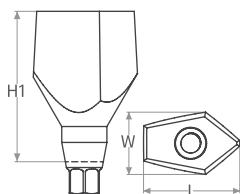

RP CloseFit™ Scan Body 7mm



RP CloseFit™ Scan Body 10mm



| | | |
|--------------------------|------------------------------------|-------------------------------------|
| Catalog No. | RP0088 | RP0089 |
| Retaining Screw Included | RP0001 | RP0001 |
| Material | TI 6Al 4V ELI | TI 6Al 4V ELI |
| Dimensions | H1: 7 mm W: 4.3 mm L: 6.7 mm | H1: 10 mm W: 4.5 mm L: 6.9 mm |

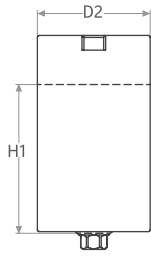

RP CloseFit™
Ti Pre Milled MDTK
Abutment Blank
Ø11.5mm

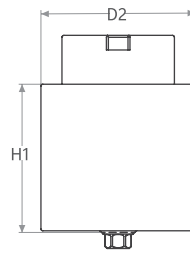

RP CloseFit™
Ti Pre Milled MDTK
Abutment Blank
Ø15.8mm



| | | | |
|--------------------------|--|--------------------------|--|
| Catalog No. | RP1211 | Catalog No. | RP1215 |
| Retaining Screw Included | RP0001 | Retaining Screw Included | RP0001 |
| Material | TI 6Al 4V ELI | Material | TI 6Al 4V ELI |
| Dimensions | H1: 15.2 mm D2: Ø11.5 mm | Dimensions | H1: 15.2 mm D2: Ø15.8 mm |
| Intended Use | customized abutment for single unit | Intended Use | customized abutment for single unit |

Ti Base

Engaged

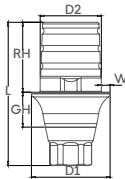

RH GH D1 D2 L W

| | | | | | | | |
|----------------|---|----------|----------|------------|------------|-------------|------------|
| TB03411 | Ti Base RP Abutment, RH 4mm GH 1mm Engaged | 4 | 1 | 4.5 | 3.5 | 7.2 | 0.5 |
| TB03421 | Ti Base RP Abutment, RH 4mm GH 2mm Engaged | 4 | 2 | 4.5 | 3.5 | 8.2 | 0.5 |
| TB03431 | Ti Base RP Abutment, RH 4mm GH 3mm Engaged | 4 | 3 | 4.5 | 3.5 | 9.2 | 0.5 |
| TB03441 | Ti Base RP Abutment, RH 4mm GH 4mm Engaged | 4 | 4 | 4.5 | 3.5 | 10.2 | 0.5 |
| TB03611 | Ti Base RP Abutment, RH 6mm GH 1mm Engaged | 6 | 1 | 4.5 | 3.5 | 9.2 | 0.5 |
| TB03621 | Ti Base RP Abutment, RH 6mm GH 2mm Engaged | 6 | 2 | 4.5 | 3.5 | 10.2 | 0.5 |
| TB03631 | Ti Base RP Abutment, RH 6mm GH 3mm Engaged | 6 | 3 | 4.5 | 3.5 | 11.2 | 0.5 |
| TB03641 | Ti Base RP Abutment, RH 6mm GH 4mm Engaged | 6 | 4 | 4.5 | 3.5 | 12.2 | 0.5 |
| TB03811 | Ti Base RP Abutment, RH 8mm GH 1mm Engaged | 8 | 1 | 4.5 | 3.5 | 11.2 | 0.5 |
| TB03821 | Ti Base RP Abutment, RH 8mm GH 2mm Engaged | 8 | 2 | 4.5 | 3.5 | 12.2 | 0.5 |
| TB03831 | Ti Base RP Abutment, RH 8mm GH 3mm Engaged | 8 | 3 | 4.5 | 3.5 | 13.2 | 0.5 |
| TB03841 | Ti Base RP Abutment, RH 8mm GH 4mm Engaged | 8 | 4 | 4.5 | 3.5 | 14.2 | 0.5 |

Non Engaged

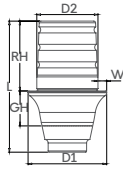

| | | RH | GH | D1 | D2 | L | W |
|----------------|---|----------|----------|------------|------------|-------------|------------|
| TB03412 | Ti Base RP Abutment, RH 4mm GH 1mm Non Engaged | 4 | 1 | 4.5 | 3.5 | 6.5 | 0.5 |
| TB03422 | Ti Base RP Abutment, RH 4mm GH 2mm Non Engaged | 4 | 2 | 4.5 | 3.5 | 7.5 | 0.5 |
| TB03432 | Ti Base RP Abutment, RH 4mm GH 3mm Non Engaged | 4 | 3 | 4.5 | 3.5 | 8.5 | 0.5 |
| TB03442 | Ti Base RP Abutment, RH 4mm GH 4mm Non Engaged | 4 | 4 | 4.5 | 3.5 | 9.5 | 0.5 |
| TB03612 | Ti Base RP Abutment, RH 6mm GH 1mm Non Engaged | 6 | 1 | 4.5 | 3.5 | 8.5 | 0.5 |
| TB03622 | Ti Base RP Abutment, RH 6mm GH 2mm Non Engaged | 6 | 2 | 4.5 | 3.5 | 9.5 | 0.5 |
| TB03632 | Ti Base RP Abutment, RH 6mm GH 3mm Non Engaged | 6 | 3 | 4.5 | 3.5 | 10.5 | 0.5 |
| TB03642 | Ti Base RP Abutment, RH 6mm GH 4mm Non Engaged | 6 | 4 | 4.5 | 3.5 | 11.5 | 0.5 |
| TB03812 | Ti Base RP Abutment, RH 8mm GH 1mm Non Engaged | 8 | 1 | 4.5 | 3.5 | 10.5 | 0.5 |
| TB03822 | Ti Base RP Abutment, RH 8mm GH 2mm Non Engaged | 8 | 2 | 4.5 | 3.5 | 11.5 | 0.5 |
| TB03832 | Ti Base RP Abutment, RH 8mm GH 3mm Non Engaged | 8 | 3 | 4.5 | 3.5 | 12.5 | 0.5 |
| TB03842 | Ti Base RP Abutment, RH 8mm GH 4mm Non Engaged | 8 | 4 | 4.5 | 3.5 | 13.5 | 0.5 |

Angular Engaged

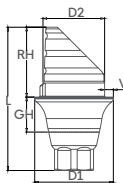

| | | RH | GH | D1 | D2 | L | W |
|----------------|---|----------|----------|------------|------------|-------------|------------|
| TB03413 | Ti Base RP Abutment, RH 4mm GH 1mm Angular Engaged | 4 | 1 | 4.5 | 3.5 | 7.2 | 0.5 |
| TB03423 | Ti Base RP Abutment, RH 4mm GH 2mm Angular Engaged | 4 | 2 | 4.5 | 3.5 | 8.2 | 0.5 |
| TB03433 | Ti Base RP Abutment, RH 4mm GH 3mm Angular Engaged | 4 | 3 | 4.5 | 3.5 | 9.2 | 0.5 |
| TB03443 | Ti Base RP Abutment, RH 4mm GH 4mm Angular Engaged | 4 | 4 | 4.5 | 3.5 | 10.2 | 0.5 |
| TB03613 | Ti Base RP Abutment, RH 6mm GH 1mm Angular Engaged | 6 | 1 | 4.5 | 3.5 | 9.2 | 0.5 |
| TB03623 | Ti Base RP Abutment, RH 6mm GH 2mm Angular Engaged | 6 | 2 | 4.5 | 3.5 | 10.2 | 0.5 |
| TB03633 | Ti Base RP Abutment, RH 6mm GH 3mm Angular Engaged | 6 | 3 | 4.5 | 3.5 | 11.2 | 0.5 |
| TB03643 | Ti Base RP Abutment, RH 6mm GH 4mm Angular Engaged | 6 | 4 | 4.5 | 3.5 | 12.2 | 0.5 |
| TB03813 | Ti Base RP Abutment, RH 8mm GH 1mm Angular Engaged | 8 | 1 | 4.5 | 3.5 | 11.2 | 0.5 |
| TB03823 | Ti Base RP Abutment, RH 8mm GH 2mm Angular Engaged | 8 | 2 | 4.5 | 3.5 | 12.2 | 0.5 |
| TB03833 | Ti Base RP Abutment, RH 8mm GH 3mm Angular Engaged | 8 | 3 | 4.5 | 3.5 | 13.2 | 0.5 |
| TB03843 | Ti Base RP Abutment, RH 8mm GH 4mm Angular Engaged | 8 | 4 | 4.5 | 3.5 | 14.2 | 0.5 |

C-Type Ti Bases | For further product information and use please refer to IFU028

Engaged

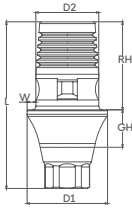

RH GH D1 D2 L W Post

| | | | | | | | | |
|---------|--|-----|---|-----|-----|-----|-----|-------|
| TB03414 | C-Type Ti Base RP Abutment, GH 1mm Engaged | 4.7 | 1 | 4.1 | 3.1 | 6.8 | 0.5 | Large |
| TB03424 | C-Type Ti Base RP Abutment, GH 2mm Engaged | 4.7 | 2 | 4.1 | 3.1 | 7.3 | 0.5 | Large |
| TB03434 | C-Type Ti Base RP Abutment, GH 3mm Engaged | 4.7 | 3 | 4.1 | 3.1 | 8.3 | 0.5 | Large |
| TB03444 | C-Type Ti Base RP Abutment, GH 4mm Engaged | 4.7 | 4 | 4.1 | 3.1 | 9.3 | 0.5 | Large |

Non Engaged

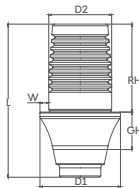

RH GH D1 D2 L W Post

| | | | | | | | | |
|---------|--|-----|---|-----|-----|-----|-----|-------|
| TB03415 | C-Type Ti Base RP Abutment, GH 1mm Non Engaged | 4.7 | 1 | 4.1 | 3.1 | 6.8 | 0.5 | Large |
| TB03425 | C-Type Ti Base RP Abutment, GH 2mm Non Engaged | 4.7 | 2 | 4.1 | 3.1 | 7.3 | 0.5 | Large |
| TB03435 | C-Type Ti Base RP Abutment, GH 3mm Non Engaged | 4.7 | 3 | 4.1 | 3.1 | 8.3 | 0.5 | Large |
| TB03445 | C-Type Ti Base RP Abutment, GH 4mm Non Engaged | 4.7 | 4 | 4.1 | 3.1 | 9.3 | 0.5 | Large |

CloseFit™ WP

Conical-Hex Connection

Ø4.3/5.0

Wide Platform

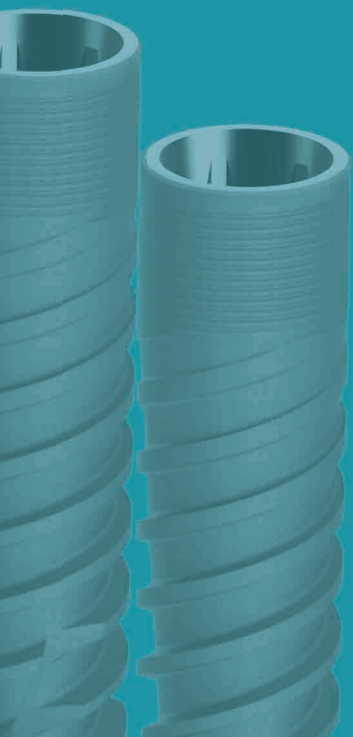



CloseFit™ WP Ø 4.3 Ø 5.0

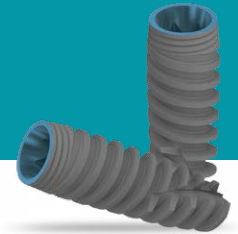

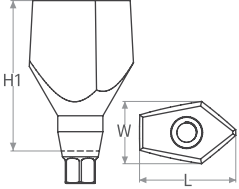

Wide Platform for wide / large ridges and spaces

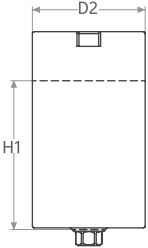

Scan body | For Intra-oral and Desktop Scanner

| | WP CloseFit™ Scan Body 7mm | WP CloseFit™ Scan Body 10mm |
|--|--|--|
|  |  |  |
| Catalog No. | WP0088 | WP0089 |
| Retaining Screw Included | WP0001 | WP0001 |
| Material | Ti 6Al 4V ELI | Ti 6Al 4V ELI |
| Dimensions | H1: 7 mm W: 4.3 mm L: 6.7 mm | H1: 10 mm W: 4.5 mm L: 6.9 mm |

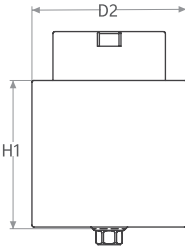
Ti Blanks | For Medentika PreFace® Holders

| | WP CloseFit™ Ti Pre Milled MDTK Abutment Blank Ø11.5mm | | WP CloseFit™ Ti Pre Milled MDTK Abutment Blank Ø15.8mm |
|---|---|---|---|
|  |  |  |  |
| Catalog No. | WP1311 | Catalog No. | WP1315 |
| Retaining Screw Included | WP0001 | Retaining Screw Included | WP0001 |
| Material | Ti 6Al 4V ELI | Material | Ti 6Al 4V ELI |
| Dimensions | H1: 15.2 mm D2: Ø11.5 mm | Dimensions | H1: 15.2 mm D2: Ø15.8 mm |
| Intended Use | customized abutment for single unit | Intended Use | customized abutment for single unit |

Ti Bases

Engaged

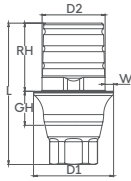

RH GH D1 D2 L W

| | | RH | GH | D1 | D2 | L | W |
|----------------|---|----------|----------|------------|------------|-------------|------------|
| TB05411 | Ti Base WP Abutment, RH 4mm GH 1mm Engaged | 4 | 1 | 4.7 | 3.7 | 7.3 | 0.5 |
| TB05421 | Ti Base WP Abutment, RH 4mm GH 2mm Engaged | 4 | 2 | 4.7 | 3.7 | 8.3 | 0.5 |
| TB05431 | Ti Base WP Abutment, RH 4mm GH 3mm Engaged | 4 | 3 | 4.7 | 3.7 | 9.3 | 0.5 |
| TB05441 | Ti Base WP Abutment, RH 4mm GH 4mm Engaged | 4 | 4 | 4.7 | 3.7 | 10.3 | 0.5 |
| TB05611 | Ti Base WP Abutment, RH 6mm GH 1mm Engaged | 6 | 1 | 4.7 | 3.7 | 9.3 | 0.5 |
| TB05621 | Ti Base WP Abutment, RH 6mm GH 2mm Engaged | 6 | 2 | 4.7 | 3.7 | 10.3 | 0.5 |
| TB05631 | Ti Base WP Abutment, RH 6mm GH 3mm Engaged | 6 | 3 | 4.7 | 3.7 | 11.3 | 0.5 |
| TB05641 | Ti Base WP Abutment, RH 6mm GH 4mm Engaged | 6 | 4 | 4.7 | 3.7 | 12.3 | 0.5 |
| TB05811 | Ti Base WP Abutment, RH 8mm GH 1mm Engaged | 8 | 1 | 4.7 | 3.7 | 11.3 | 0.5 |
| TB05821 | Ti Base WP Abutment, RH 8mm GH 2mm Engaged | 8 | 2 | 4.7 | 3.7 | 12.3 | 0.5 |
| TB05831 | Ti Base WP Abutment, RH 8mm GH 3mm Engaged | 8 | 3 | 4.7 | 3.7 | 13.3 | 0.5 |
| TB05841 | Ti Base WP Abutment, RH 8mm GH 4mm Engaged | 8 | 4 | 4.7 | 3.7 | 14.3 | 0.5 |

Engaged Wide

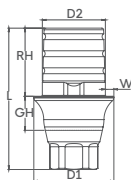

RH GH D1 D2 L W

| | | RH | GH | D1 | D2 | L | W |
|----------|--|----|----|-----|-----|------|-----|
| TB05411W | Ti Base WP Abutment, RH 4mm GH 1mm Engaged, Wide | 4 | 1 | 5.5 | 3.7 | 7.3 | 0.9 |
| TB05421W | Ti Base WP Abutment, RH 4mm GH 2mm Engaged Wide | 4 | 2 | 5.5 | 3.7 | 8.3 | 0.9 |
| TB05431W | Ti Base WP Abutment, RH 4mm GH 3mm Engaged Wide | 4 | 3 | 5.5 | 3.7 | 9.3 | 0.9 |
| TB05441W | Ti Base WP Abutment, RH 4mm GH 4mm Engaged Wide | 4 | 4 | 5.5 | 3.7 | 10.3 | 0.9 |
| TB05611W | Ti Base WP Abutment, RH 6mm GH 1mm Engaged Wide | 6 | 1 | 5.5 | 3.7 | 9.3 | 0.9 |
| TB05621W | Ti Base WP Abutment, RH 6mm GH 2mm Engaged Wide | 6 | 2 | 5.5 | 3.7 | 10.3 | 0.9 |
| TB05631W | Ti Base WP Abutment, RH 6mm GH 3mm Engaged Wide | 6 | 3 | 5.5 | 3.7 | 11.3 | 0.9 |
| TB05641W | Ti Base WP Abutment, RH 6mm GH 4mm Engaged Wide | 6 | 4 | 5.5 | 3.7 | 12.3 | 0.9 |
| TB05811W | Ti Base WP Abutment, RH 8mm GH 1mm Engaged Wide | 8 | 1 | 5.5 | 3.7 | 11.3 | 0.9 |
| TB05821W | Ti Base WP Abutment, RH 8mm GH 2mm Engaged Wide | 8 | 2 | 5.5 | 3.7 | 12.3 | 0.9 |
| TB05831W | Ti Base WP Abutment, RH 8mm GH 3mm Engaged Wide | 8 | 3 | 5.5 | 3.7 | 13.3 | 0.9 |
| TB05841W | Ti Base WP Abutment, RH 8mm GH 4mm Engaged Wide | 8 | 4 | 5.5 | 3.7 | 14.3 | 0.9 |

Non Engaged

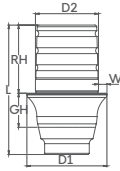

| | | RH | GH | D1 | D2 | L | W |
|----------------|---|----------|----------|------------|------------|-------------|------------|
| TB05412 | Ti Base WP Abutment, RH 4mm GH 1mm Non Engaged | 4 | 1 | 4.7 | 3.7 | 6.6 | 0.5 |
| TB05422 | Ti Base WP Abutment, RH 4mm GH 2mm Non Engaged | 4 | 2 | 4.7 | 3.7 | 7.6 | 0.5 |
| TB05432 | Ti Base WP Abutment, RH 4mm GH 3mm Non Engaged | 4 | 3 | 4.7 | 3.7 | 8.6 | 0.5 |
| TB05442 | Ti Base WP Abutment, RH 4mm GH 4mm Non Engaged | 4 | 4 | 4.7 | 3.7 | 9.6 | 0.5 |
| TB05612 | Ti Base WP Abutment, RH 6mm GH 1mm Non Engaged | 6 | 1 | 4.7 | 3.7 | 8.6 | 0.5 |
| TB05622 | Ti Base WP Abutment, RH 6mm GH 2mm Non Engaged | 6 | 2 | 4.7 | 3.7 | 9.6 | 0.5 |
| TB05632 | Ti Base WP Abutment, RH 6mm GH 3mm Non Engaged | 6 | 3 | 4.7 | 3.7 | 10.6 | 0.5 |
| TB05642 | Ti Base WP Abutment, RH 6mm GH 4mm Non Engaged | 6 | 4 | 4.7 | 3.7 | 11.6 | 0.5 |
| TB05812 | Ti Base WP Abutment, RH 8mm GH 1mm Non Engaged | 8 | 1 | 4.7 | 3.7 | 10.6 | 0.5 |
| TB05822 | Ti Base WP Abutment, RH 8mm GH 2mm Non Engaged | 8 | 2 | 4.7 | 3.7 | 11.6 | 0.5 |
| TB05832 | Ti Base WP Abutment, RH 8mm GH 3mm Non Engaged | 8 | 3 | 4.7 | 3.7 | 12.6 | 0.5 |
| TB05842 | Ti Base WP Abutment, RH 8mm GH 4mm Non Engaged | 8 | 4 | 4.7 | 3.7 | 13.6 | 0.5 |

Non Engaged Wide

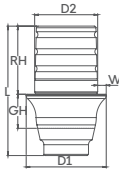

| | | RH | GH | D1 | D2 | L | W |
|----------|---|----|----|-----|-----|------|-----|
| TB05412W | Ti Base WP Abutment, RH 4mm GH 1mm Non Engaged Wide | 4 | 1 | 5.5 | 3.7 | 6.6 | 0.9 |
| TB05422W | Ti Base WP Abutment, RH 4mm GH 2mm Non Engaged Wide | 4 | 2 | 5.5 | 3.7 | 7.6 | 0.9 |
| TB05432W | Ti Base WP Abutment, RH 4mm GH 3mm Non Engaged Wide | 4 | 3 | 5.5 | 3.7 | 8.6 | 0.9 |
| TB05442W | Ti Base WP Abutment, RH 4mm GH 4mm Non Engaged Wide | 4 | 4 | 5.5 | 3.7 | 9.6 | 0.9 |
| TB05612W | Ti Base WP Abutment, RH 6mm GH 1mm Non Engaged Wide | 6 | 1 | 5.5 | 3.7 | 8.6 | 0.9 |
| TB05622W | Ti Base WP Abutment, RH 6mm GH 2mm Non Engaged Wide | 6 | 2 | 5.5 | 3.7 | 9.6 | 0.9 |
| TB05632W | Ti Base WP Abutment, RH 6mm GH 3mm Non Engaged Wide | 6 | 3 | 5.5 | 3.7 | 10.6 | 0.9 |
| TB05642W | Ti Base WP Abutment, RH 6mm GH 4mm Non Engaged Wide | 6 | 4 | 5.5 | 3.7 | 11.6 | 0.9 |
| TB05812W | Ti Base WP Abutment, RH 8mm GH 1mm Non Engaged Wide | 8 | 1 | 5.5 | 3.7 | 10.6 | 0.9 |
| TB05822W | Ti Base WP Abutment, RH 8mm GH 2mm Non Engaged Wide | 8 | 2 | 5.5 | 3.7 | 11.6 | 0.9 |
| TB05832W | Ti Base WP Abutment, RH 8mm GH 3mm Non Engaged Wide | 8 | 3 | 5.5 | 3.7 | 12.6 | 0.9 |
| TB05842W | Ti Base WP Abutment, RH 8mm GH 4mm Non Engaged Wide | 8 | 4 | 5.5 | 3.7 | 13.6 | 0.9 |

Angular Engaged

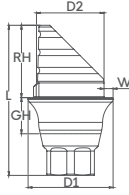

| | | RH | GH | D1 | D2 | L | W |
|----------------|---|----------|----------|------------|------------|-------------|------------|
| TB05413 | Ti Base WP Abutment, RH 4mm GH 1mm Angular Engaged | 4 | 1 | 4.7 | 3.7 | 7.3 | 0.5 |
| TB05423 | Ti Base WP Abutment, RH 4mm GH 2mm Angular Engaged | 4 | 2 | 4.7 | 3.7 | 8.3 | 0.5 |
| TB05433 | Ti Base WP Abutment, RH 4mm GH 3mm Angular Engaged | 4 | 3 | 4.7 | 3.7 | 9.3 | 0.5 |
| TB05443 | Ti Base WP Abutment, RH 4mm GH 4mm Angular Engaged | 4 | 4 | 4.7 | 3.7 | 10.3 | 0.5 |
| TB05613 | Ti Base WP Abutment, RH 6mm GH 1mm Angular Engaged | 6 | 1 | 4.7 | 3.7 | 9.3 | 0.5 |
| TB05623 | Ti Base WP Abutment, RH 6mm GH 2mm Angular Engaged | 6 | 2 | 4.7 | 3.7 | 10.3 | 0.5 |
| TB05633 | Ti Base WP Abutment, RH 6mm GH 3mm Angular Engaged | 6 | 3 | 4.7 | 3.7 | 11.3 | 0.5 |
| TB05643 | Ti Base WP Abutment, RH 6mm GH 4mm Angular Engaged | 6 | 4 | 4.7 | 3.7 | 12.3 | 0.5 |
| TB05813 | Ti Base WP Abutment, RH 8mm GH 1mm Angular Engaged | 8 | 1 | 4.7 | 3.7 | 11.3 | 0.5 |
| TB05823 | Ti Base WP Abutment, RH 8mm GH 2mm Angular Engaged | 8 | 2 | 4.7 | 3.7 | 12.3 | 0.5 |
| TB05833 | Ti Base WP Abutment, RH 8mm GH 3mm Angular Engaged | 8 | 3 | 4.7 | 3.7 | 13.3 | 0.5 |
| TB05843 | Ti Base WP Abutment, RH 8mm GH 4mm Angular Engaged | 8 | 4 | 4.7 | 3.7 | 14.3 | 0.5 |

Angular Engaged Wide

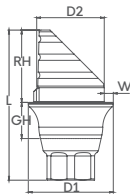

| | | RH | GH | D1 | D2 | L | W |
|----------|---|----|----|-----|-----|------|-----|
| TB05413W | Ti Base WP Abutment, RH 4mm GH 1mm Angular Engaged Wide | 4 | 1 | 5.5 | 3.7 | 7.3 | 0.9 |
| TB05423W | Ti Base WP Abutment, RH 4mm GH 2mm Angular Engaged Wide | 4 | 2 | 5.5 | 3.7 | 8.3 | 0.9 |
| TB05433W | Ti Base WP Abutment, RH 4mm GH 3mm Angular Engaged Wide | 4 | 3 | 5.5 | 3.7 | 9.3 | 0.9 |
| TB05443W | Ti Base WP Abutment, RH 4mm GH 4mm Angular Engaged Wide | 4 | 4 | 5.5 | 3.7 | 10.3 | 0.9 |
| TB05613W | Ti Base WP Abutment, RH 6mm GH 1mm Angular Engaged Wide | 6 | 1 | 5.5 | 3.7 | 9.3 | 0.9 |
| TB05623W | Ti Base WP Abutment, RH 6mm GH 2mm Angular Engaged Wide | 6 | 2 | 5.5 | 3.7 | 10.3 | 0.9 |
| TB05633W | Ti Base WP Abutment, RH 6mm GH 3mm Angular Engaged Wide | 6 | 3 | 5.5 | 3.7 | 11.3 | 0.9 |
| TB05643W | Ti Base WP Abutment, RH 6mm GH 4mm Angular Engaged Wide | 6 | 4 | 5.5 | 3.7 | 12.3 | 0.9 |
| TB05813W | Ti Base WP Abutment, RH 8mm GH 1mm Angular Engaged Wide | 8 | 1 | 5.5 | 3.7 | 11.3 | 0.9 |
| TB05823W | Ti Base WP Abutment, RH 8mm GH 2mm Angular Engaged Wide | 8 | 2 | 5.5 | 3.7 | 12.3 | 0.9 |
| TB05833W | Ti Base WP Abutment, RH 8mm GH 3mm Angular Engaged Wide | 8 | 3 | 5.5 | 3.7 | 13.3 | 0.9 |
| TB05843W | Ti Base WP Abutment, RH 8mm GH 4mm Angular Engaged Wide | 8 | 4 | 5.5 | 3.7 | 14.3 | 0.9 |

C-Type Ti Bases | For further product information and use please refer to IFU028

Engaged

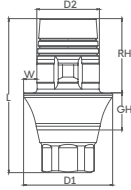

RH GH D1 D2 L W Post

| | | | | | | | | |
|---------|--|---|---|-----|------|------|-----|-------|
| TB05414 | C-Type Ti Base WP Abutment, GH 1mm Engaged | 4 | 1 | 4.8 | 3.37 | 7.3 | 0.7 | Large |
| TB05424 | C-Type Ti Base WP Abutment, GH 2mm Engaged | 4 | 2 | 4.8 | 3.37 | 8.3 | 0.7 | Large |
| TB05434 | C-Type Ti Base WP Abutment, GH 3mm Engaged | 4 | 3 | 4.8 | 3.37 | 9.3 | 0.7 | Large |
| TB05444 | C-Type Ti Base WP Abutment, GH 4mm Engaged | 4 | 4 | 4.8 | 3.37 | 10.3 | 0.7 | Large |

Engaged Wide

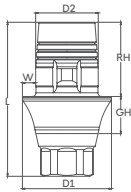

RH GH D1 D2 L W Post

| | | | | | | | | |
|----------|---|---|---|---|------|-----|-----|-------|
| TB05414W | C-Type Ti Base WP Abutment, GH 1mm Engaged Wide | 4 | 1 | 6 | 3.37 | 6.6 | 1.3 | Large |
| TB05424W | C-Type Ti Base WP Abutment, GH 2mm Engaged Wide | 4 | 2 | 6 | 3.37 | 7.6 | 1.3 | Large |
| TB05434W | C-Type Ti Base WP Abutment, GH 3mm Engaged Wide | 4 | 3 | 6 | 3.37 | 8.6 | 1.3 | Large |
| TB05444W | C-Type Ti Base WP Abutment, GH 4mm Engaged Wide | 4 | 4 | 6 | 3.37 | 9.6 | 1.3 | Large |

Non Engaged

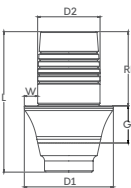

RH GH D1 D2 L W Post

| | | | | | | | | |
|---------|--|---|---|-----|------|------|-----|-------|
| TB05415 | C-Type Ti Base WP Abutment, GH 1mm Non Engaged | 4 | 1 | 4.8 | 3.37 | 7.3 | 0.7 | Large |
| TB05425 | C-Type Ti Base WP Abutment, GH 2mm Non Engaged | 4 | 2 | 4.8 | 3.37 | 8.3 | 0.7 | Large |
| TB05435 | C-Type Ti Base WP Abutment, GH 3mm Non Engaged | 4 | 3 | 4.8 | 3.37 | 9.3 | 0.7 | Large |
| TB05445 | C-Type Ti Base WP Abutment, GH 4mm Non Engaged | 4 | 4 | 4.8 | 3.37 | 10.3 | 0.7 | Large |

Non Engaged Wide

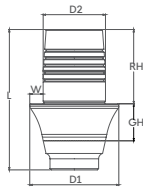

| | | RH | GH | D1 | D2 | L | W | Post |
|----------|---|----|----|----|------|-----|-----|-------|
| TB05415W | C-Type Ti Base WP Abutment, GH 1mm Non Engaged Wide | 4 | 1 | 6 | 3.37 | 6.6 | 1.3 | Large |
| TB05425W | C-Type Ti Base WP Abutment, GH 2mm Non Engaged Wide | 4 | 2 | 6 | 3.37 | 7.6 | 1.3 | Large |
| TB05435W | C-Type Ti Base WP Abutment, GH 3mm Non Engaged Wide | 4 | 3 | 6 | 3.37 | 8.6 | 1.3 | Large |
| TB05445W | C-Type Ti Base WP Abutment, GH 4mm Non Engaged Wide | 4 | 4 | 6 | 3.37 | 9.6 | 1.3 | Large |

TMA

Multi Unit

For Screw Retained Restoration



TMA

Multi Unit

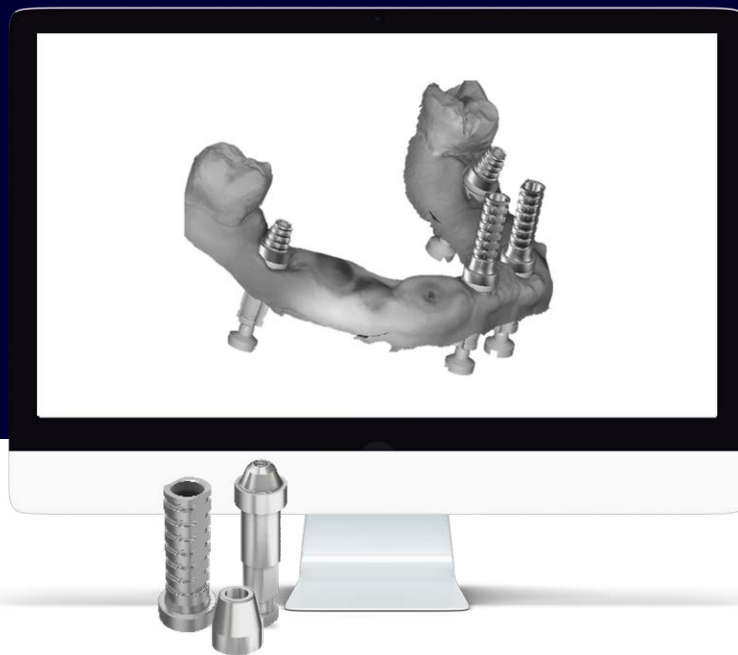

For Screw Retained Restoration

Scan body | Para escáner intraoral y de escritorio

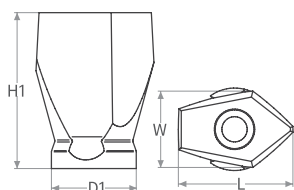

Scan Body para TMA de 6 mm

Scan Body para TMA de 9mm



Catalog No.

TM0006

TM0009

Tornillo de Scan Body para TMA incluido

TM0001

TM0001

Material

TI 6Al 4V ELI

TI 6Al 4V ELI

Dimensiones

H1: 6 mm
D1: Ø4,9 mm
W: 4,3 mm
L: 6,7 mm

H1: 9 mm
D1: Ø4,9 mm
W: 4,5 mm
L: 6,8 mm

| | | L | D1 | Catalog | | | L | D1 | Catalog |
|--|---|-----|-----|---------|--|---|-----|-----|---------|
|  | Scan Body No rotatorio para TMA de 6 mm | 6.0 | 4.9 | TM0006S |  | Scan Body No rotatorio para TMA de 9 mm | 9.0 | 4.9 | TM0009S |

Cono de cementación y cilindro temporal

Cono de cementación rotatorio para TMA

Cilindro temporal rotatorio para TMA

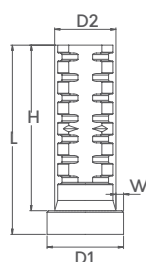
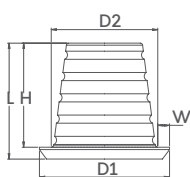

Catalog No.

TM0011

Catalog No.

RS4900

Tornillo de Scan Body para TMA incluido.

TM0001

Tornillo de prótesis TMA incluido

RS3404

Material

TI 6Al 4V ELI

Material

TI 6Al 4V ELI

Dimensiones

L: 4,9 mm
H: 4,4 mm
D1: Ø5,5 mm
D2: Ø4,5 mm
W: 0,5 mm

Dimensiones

L: 12 mm
H: 10,5 mm
D1: Ø4,9 mm
D2: Ø3,6 mm
W: 0,5 mm

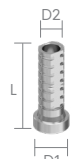
| | | L | D1 | D2 | Catalog | | L | D1 | D2 | H | Catalog | |
|---|---|-----|-----|-----|---------|---|---|------|-----|-----|---------|---------|
|  | Cono de cementación No rotatorio para TMA | 4.9 | 5.5 | 3.2 | TM0011S |  | Cilindro temporal No rotatorio para TMA | 12.0 | 4.9 | 3.5 | 10.5 | RS4900S |

Accessories

Screws, Tools, Anologs & Replica

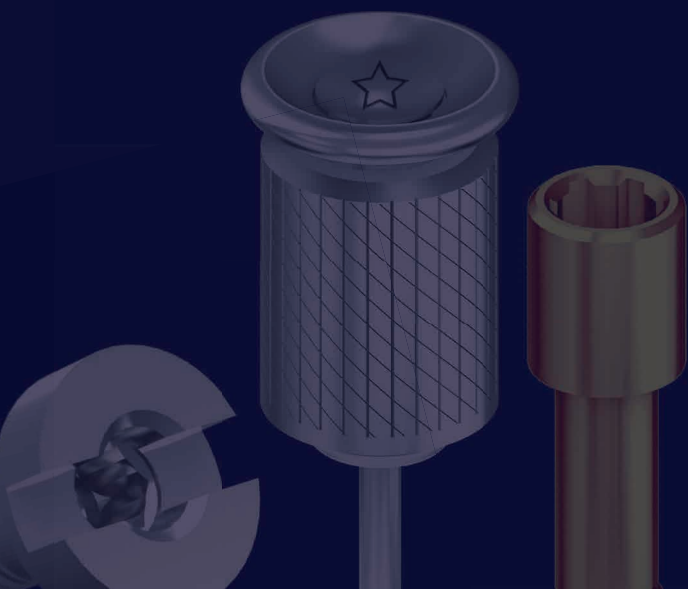



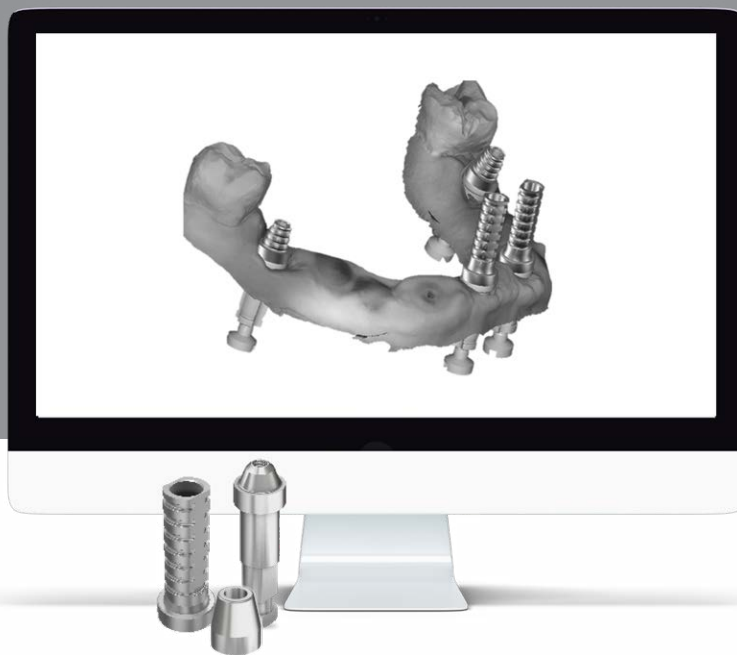

Accessories

Screws | Tools | Analogs | Replica





For Screw Retained Restoration

Screws





| CloseFit™ Conical Connection | UNP CloseFit™ Abutment Screw | NP CloseFit™ Abutment Screw | RP CloseFit™ Abutment Screw | WP CloseFit™ Abutment Screw |
|---------------------------------|---|---|---|---|
| |  |  |  |  |
| Catalog No. | | NP0001 | RP0001 | WP0001 |
| Material | | Ti 6Al 4V ELI | Ti 6Al 4V ELI | Ti 6Al 4V ELI |
| Intended use | | For NP Scan Body, Ti Bases and Blanks | For RP Scan Body, Ti Bases and Blanks | For WP Scan Body, Ti Bases and Blanks |



| Touareg™ RS Internal Hex | RS Prosthetic Screw | RS Screw For Closed Tray Transfer | RS Short Prosthetic Screw |
|-----------------------------|---|---|---|
| |  |  |  |
| Catalog No. | RS3400 | RS3425 | RS3402 |
| Material | Ti 6Al 4V ELI | Ti 6Al 4V ELI | Ti 6Al 4V ELI |
| Intended use | For RS Scan Body 7mm | For RS Scan Body 10mm | For RS Ti Bases and Ti Blanks |

TMA - Multi Unit

| | TMA Scan Body Screw | TMA Prosthetic Screw |
|--------------|---|---|
| |  |  |
| Catalog No. | TM0001 | RS3404 |
| Material | Ti 6Al 4V ELI | Ti 6Al 4V ELI |
| Intended use | For TMA-MU Scan Body and Cementing Cone | For TMA-MU Temporary cylinder and TMA direct option |



Analogs & Replica

| Digital Analog | UNP Digital Analog | NP Digital Analog | RP Digital Analog | WP Digital Analog |
|----------------|---|---|---|---|
| |  |  |  |  |
| Catalog No. | UNP1000 | NP1000 | RP1000 | WP1000 |
| Material | TI 6Al 4V ELI | TI 6Al 4V ELI | TI 6Al 4V ELI | TI 6Al 4V ELI |

| Digital Analog for RS & TMA- MU | RS Digital Analog | TMA Abutment Replica |
|------------------------------------|--|--|
| |  |  |
| Catalog No. | RS1000 | RS1001 |
| Material | TI 6Al 4V ELI | TI 6Al 4V ELI |

| Retaining Screw |
|---|
|  |
| RS1002 |
| TI 6Al 4V ELI |
| Compatible with TMA-MU, CloseFit™ & RS Platforms |

Tools*

| | Star Hand driver- Short | 1.27 Hex Hand Driver- Short |
|--------------|---|--|
| |  |  |
| Catalog No. | RP0064 | RS6095 |
| | Star Hand driver- Long | 1.27 Hex Hand Driver- Medium |
| Catalog No. | RP0004 | RS6094 |
| Intended use | Compatible with TMA-MU and CloseFit™ Platforms: UNP, NP, RP, WP | Compatible with Touareg™ RS System: Touareg-S™, Touareg-OS™, Swell™, Triple™ |

*You may also use any of the following: RS6097 | RP0065 | RS6080 | RP0005 | RS6082 | RP0018 | RS9030 | RP0019 | RS9035

CAD-CAM libraries allow for design and manufacture of custom made restoration products that fit Adin's implants using CAD-CAM Technology.

Adin's CAD-CAM restoration parts have been added to the Exocad, 3shape, Dental Wings, and are available for downloading on our website at: <https://www.adin-implants.com/product/cadcam/>

Adin may update its supported systems software list from time to time. The updated list will be available on Adin's website address mentioned above.

Features

- The use of CAD libraries for Temp restoration saves time and is design to be more accurate for both the doctor and the laboratory
- Titanium Temporary Cylinder (RS4900) was added to the 3D libraries in order to make the connection between the TMA and the temporary restoration
- Two different lengths of restoration were added to the libraries: Half High cylinder/ Full High cylinder
- Different options for cement were added to the libraries: 0.25 / 0.5 Cement Gap

The libraries contain

- Two Scan Body height variations fit all platforms: RS, WP, RP, NP, UNP and TMA-MU Platforms
- Ti bases: Engaged, Non-Engaged and Angular Engaged
- TMA Cementing cone and Temporary TMA restoration
- Library installation instructions
- Library files are available for downloading using the link above and are also accessible in the various software libraries.
- After downloading our library, save the library files on your computer and follow your CAD-CAM supplier loading and installation instructions in order to load and install our libraries onto your system.



About Adin

Every business starts with a vision.

Ours is simple: We want to create the best possible dental implant solutions that offer uncompromising quality at an affordable price. It's our people that help our business thrive and grow. That's why we place so much importance on building strong personal relationships that enable us to meet our doctors and distributors' needs. Understanding that their success is our success, we're focused on providing professional, high quality and affordable solutions and exceptional service that help them grow.